

# Fuel Filter

## Fuel Filter 10 / 100 micron

200-01-201 / 200-01-202 / 200-01-203

Assembly Instructions | © Nuke Performance AB 2021

For more information visit : [www.nukeperformance.com](http://www.nukeperformance.com)

- 1** Billet lightweight filter body
- 2** Filter end cap with AN-10 ORB thread
- 3** Viton O-ring 44.6 x 2.4 mm for end cap
- 4** Internal spring
- 5** Stainless steel bracket, left and right piece
- 6** 10 / 100 mic filter element
  - 10-micron cellulose filter element Part # 200-10-101
  - 10-micron stainless steel filter element Part # 200-10-105
  - 100-micron stainless steel filter element Part # 200-10-102

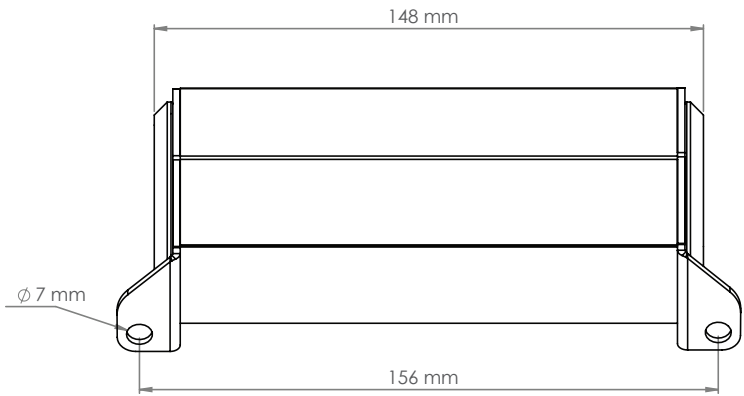
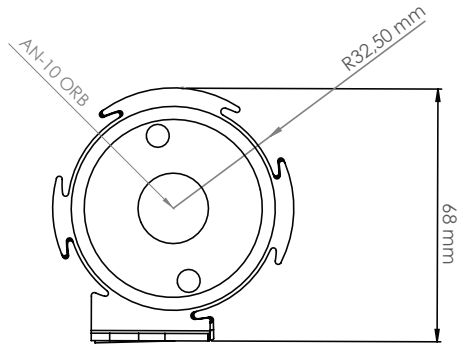
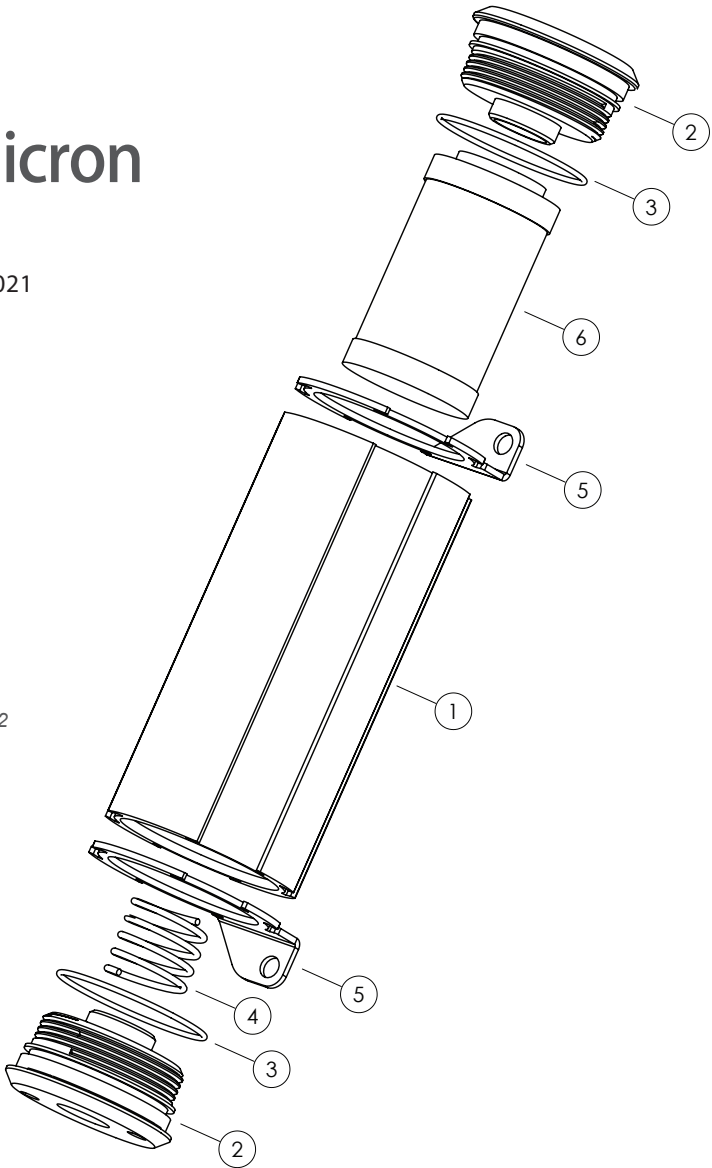

### Nuke Performance fuel filter slim specifications

For more information about specifications, visit our product page on our website.  
 Nuke Performance : [www.nukeperformance.com](http://www.nukeperformance.com)



<b>10-micron cellulose #</b>	200-01-201 (replacement # 200-10-101)	<b>Stainless steel compatibility</b>	Gasoline (Petrol), Methanol, Ethanol (E85)
<b>10-micron stainless steel #</b>	200-01-203 (replacement # 200-10-105)	<b>Flow capacity</b>	750 LPH
<b>100-micron stainless steel #</b>	200-01-202 (replacement # 200-10-102)	<b>Pressure drop</b>	≈0.15 BAR (≈2.17 PSI)
<b>Filter element micron</b>	µm 10-micron / 100-micron	<b>Length</b>	148mm (5.82")
<b>Filter element material</b>	Cellulose / Stainless steel	<b>Height</b>	68mm (2.67")
<b>Work pressure / Max pressure</b>	8 BAR (116 PSI) / 21 BAR (305 PSI)	<b>Inlet thread</b>	AN-10 ORB (no fittings included)
<b>Filter area</b>	60 sq. inches	<b>Outlet thread</b>	AN-10 ORB (no fittings included)
<b>Cellulose fuel compatibility</b>	Gasoline (Petrol)	<b>Weight</b>	720-990g (1.5-2.2lb)

**!** INCORRECT INSTALLATION CAN CAUSE SERIOUS DAMAGE TO THE PRODUCT AND VEHICLE. AS A RESULT, ACCIDENTS, PROPERTY DAMAGE, AND PERSONAL INJURY ARE POSSIBLE. INSTALLATION MAY ONLY BE CARRIED OUT BY EXPERTS. MAKE SURE TO ALWAYS USE ALL NECESSARY SAFETY EQUIPMENT. THE MANUFACTURER IS NOT LIABLE FOR DAMAGE CAUSED BY IMPROPER INSTALLATION.



**Information:**  
 Design combined with top quality performance.  
 For more information about the products and retailers visit  
[www.nukeperformance.com](http://www.nukeperformance.com)

